

# Model "150 X 120"

Available in 1,68 m x 1,38 x 2,18 and 1,68 m x 1,68 x 2,18



ENQUIRE S.L.    Studiobricks    Tel.: +34 609 865 723    Web: [www.studiobricks.com](http://www.studiobricks.com)  
 Calle Aribau 177, 1a    STUDIO BRICKS    Mail: [info@studiobricks.com](mailto:info@studiobricks.com)  
 08036 Barcelona / Spanien    NIF: B - 634 04 0 32

## A HIGH PERFORMANCE ACOUSTIC BOOTH

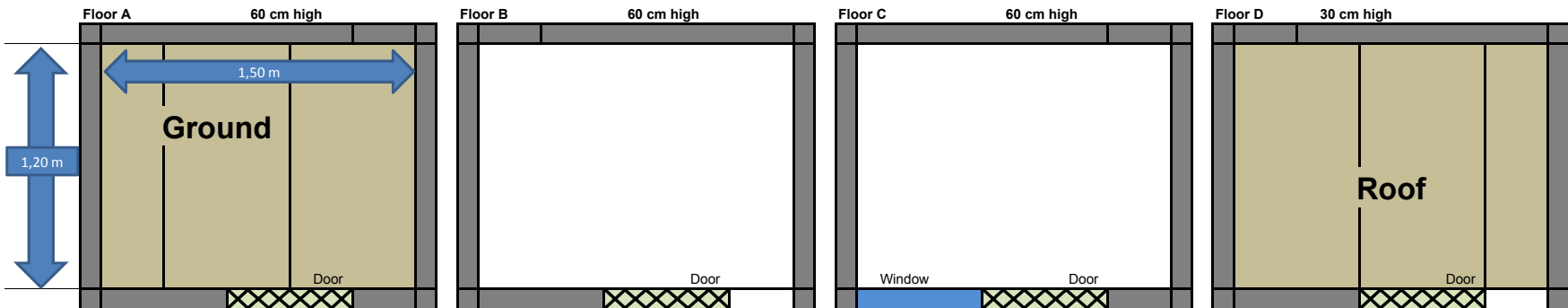
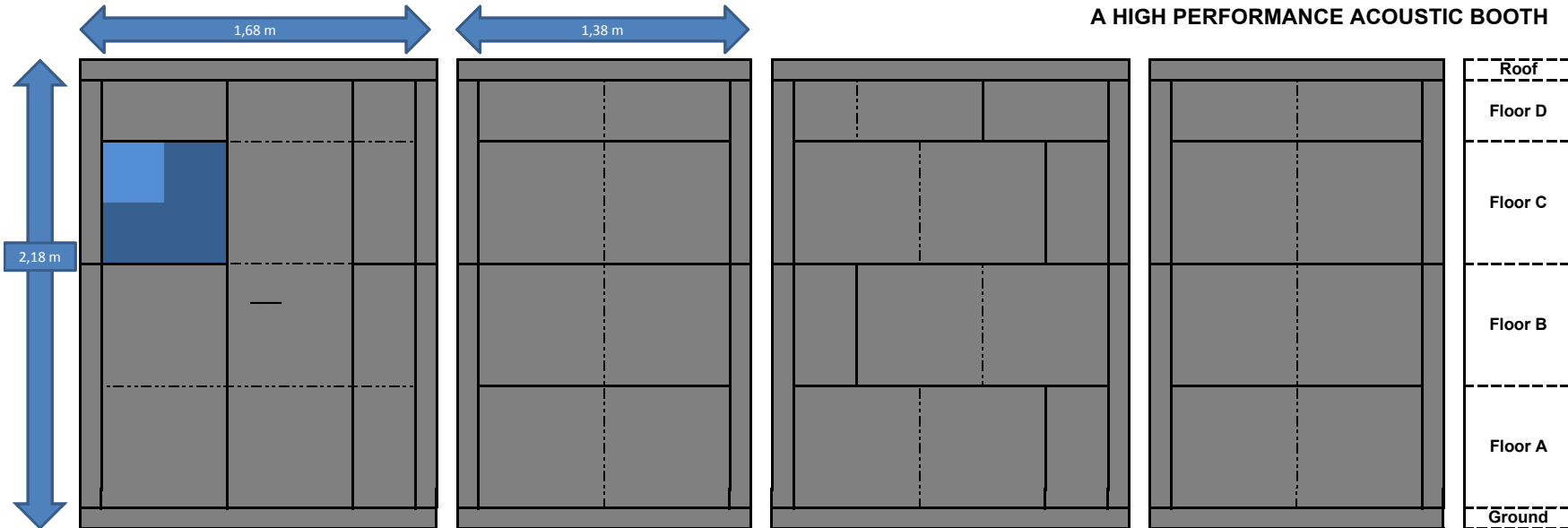

Bricks									Application	
Bricks Sizes	120 x 60	120 x 60	120 x 30	60 x 30	90 x 30	Corner	Structure	Window	Pro-Keyboards, Homerecording, Musicproduction Guitars and Basses	
Floor A	4		1	1		4				
Floor B	3			1						
Floor C	3			1	1	4		1		
Floor D			3	1	1					
Roof	2				1		4		1.) Airbox                      4.) Silent Blocks	
Ground	2				1		4		2.) Carpet                      5.) Electricity Plug	
<b>Total Bricks</b>	<b>14</b>	<b>0</b>	<b>4</b>	<b>4</b>	<b>4</b>	<b>8</b>	<b>8</b>	<b>1</b>	3.) Lights LED                6.) 5 Vicoustic acoustic panels	

# Model "150 X 120"

Available in 1,68 m x 1,38 x 2,18 and 1,68 m x 1,68 x 2,18

studiobricks

ENQUIRE S.L. Studiobricks  
Calle Aribau 177, 1a  
08036 Barcelona / Spanien

Tel.: +34 609 865 723  
STUDIO BRICKS  
NIF: B - 634 04 0 32

Web: [www.studiobricks.com](http://www.studiobricks.com)  
Mail: [info@studiobricks.com](mailto:info@studiobricks.com)

A HIGH PERFORMANCE ACOUSTIC BOOTH

Front of booth

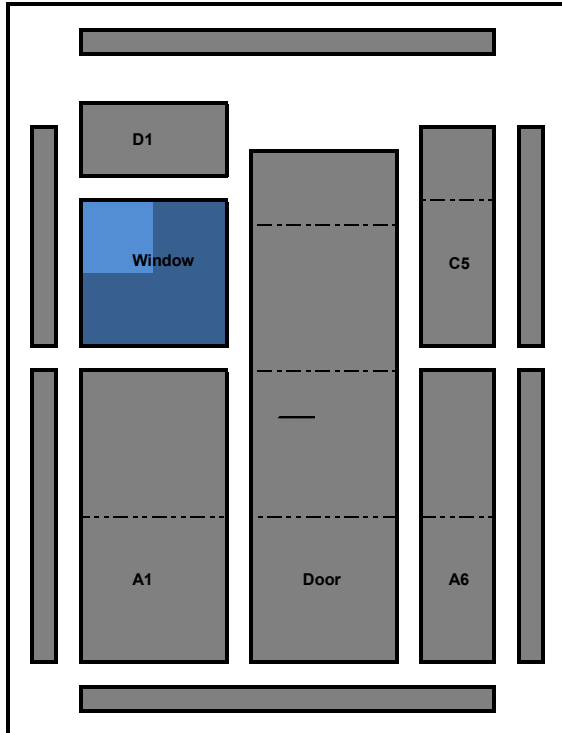

Left side of booth

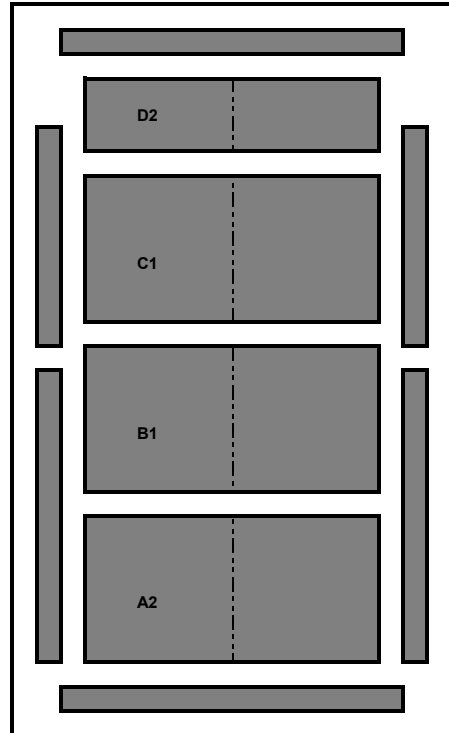

Back side of booth

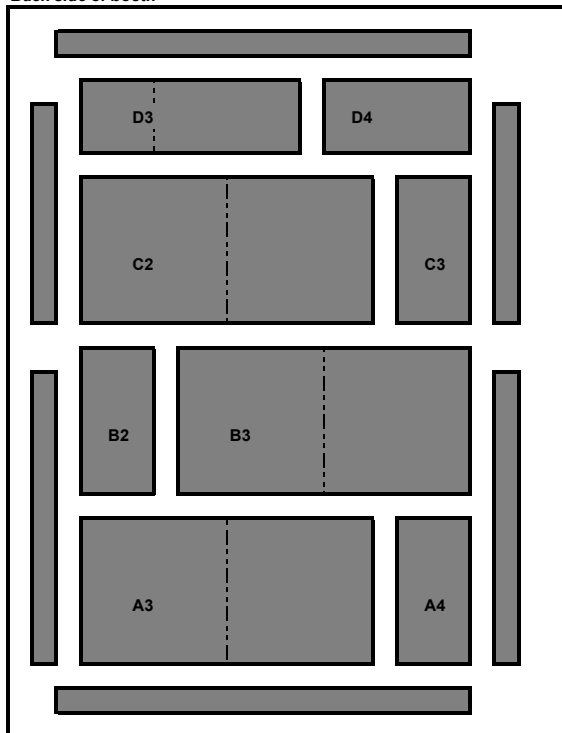

Right side of booth

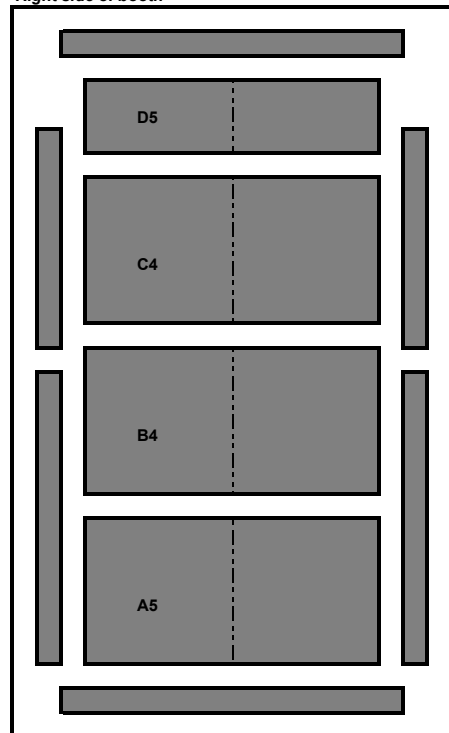

## Bricks

Sizes	120 x 60	120 x 60	120 x 30	60 x 30	90 x 30	Corner	Structure	Window
Floor A	4		1	1		4		
Floor B	3			1				
Floor C	3			1	1	4		1
Floor D			3	1	1			
Roof	2				1		4	
Ground	2				1		4	
<b>Total Bricks</b>	<b>14</b>	<b>0</b>	<b>4</b>	<b>4</b>	<b>4</b>	<b>8</b>	<b>8</b>	<b>1</b>

## Application

Pro-Keyboards, Homerecording  
Guitars and Basses  
Musicproduction, Brass & Woodw.

## Components

- 1.) Airbox
- 2.) Carpet
- 3.) Lights LED
- 4.) Silent Blocks
- 5.) Electricity Plug
- 6.) 5 Vicoustic acoustic panels